

Fonds pour reservoirs a double paroi

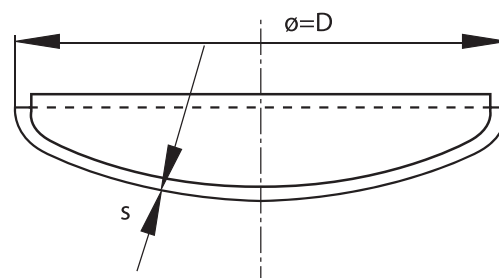

	D	s	R	r	h	Ht	Kg.	V
	1258	3	1250	50	30	230	40	180
	1508	3	1500	50	30	265	55	290
	1908	3	1900	70	30	330	85	580
	2512	5	2500	95	30	425	240	1280
	3012	5	3000	180	30	545	350	2420